

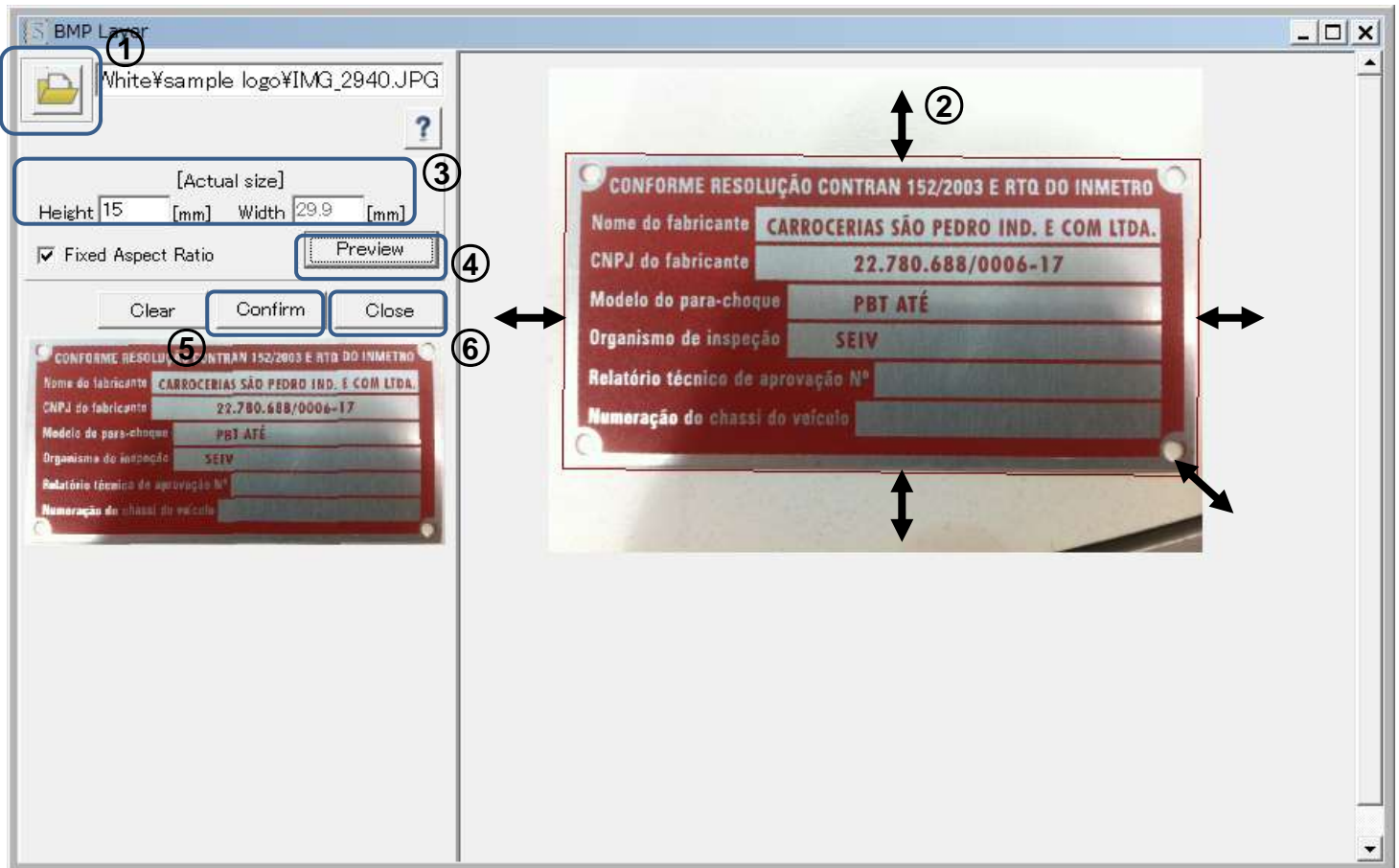

BMP Layer

Menu → View → Layer → Template Layer → Advanced Settings → BMP layer

The base layer (BMP or JPEG data) is displayed, and the field position can be set. This is helpful for position setting and positioning marking for nameplates etc.



---Instructions---

1. Click the  icon to open the BMP data or JPEG data.
2. After importing the data, trim the data on the screen using click and drag. Adjust the frame horizontally and vertically, as well as the lower right (angle), and carry out trimming in accordance with the size of the data.
3. After trimming, input the actual dimensions of the data. (If the aspect ratio is fixed just input the height dimension.)
4. Click the **Preview** button. The trimmed data is displayed on the lower left.
5. After checking the preview data, click the **Confirm** button, and save the data (*.bml) in the location of your choice.
6. Click the **Close** button to close the window.

7. From the template layer screen, click  in the shapes icon to create a field within the preview area and import the previously saved bml data. After importing, align the bml data with the marking window and set its position. ***Be sure to align the base position of the pin with that of the preview screen when marking.**

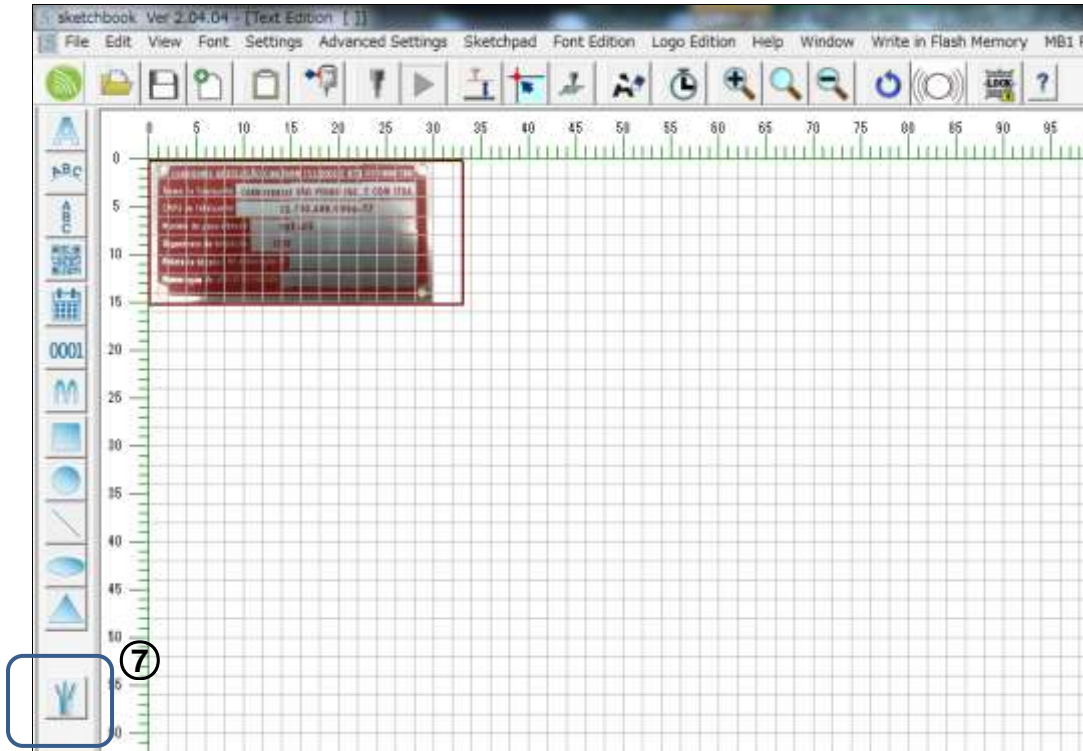

8. Return to Menu → View → Text Layer, and click  within the shapes icon the bml data will be displayed in the base layer, so create the fields on top of the base layer graphic.

